

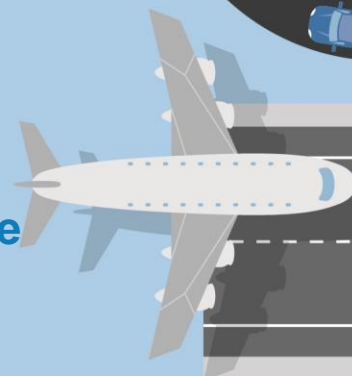

Sydney Gateway

Pipeline investigation works on Airport Drive and Qantas Drive, June to December 2020



We will be digging at four locations along Airport Drive and Qantas Drive in Mascot.

These works form part of early preparations that will help us to build Sydney Gateway.

What does our work involve?

We will be using an excavator to expose sections of the existing primary gas pipeline at each site.

We will be checking the condition of the gas main to ensure that we can safely move it in the future, to accommodate the main road works that are planned in the area.

How will we conduct our work?

We will stage the work one by one to reduce impacts to drivers, cyclists and pedestrians.

Work areas are shown on the map over the page.

Our work schedule

We will work on **Mondays to Saturdays** from **June to December**, weather permitting.

The team will be working at each location for approximately four to six weeks.

Work hours will be between:

- Weekdays 7am – 6pm
- Saturdays 8am – 1pm

To minimise impacts on traffic and for the safety of our workers, motorists, cyclists and pedestrians night works may be required. Night works would take place between 7pm – 5am.

How will our work affect you?

There will be no noise impact to surrounding businesses.

Lane closures will be in place during both day and night works. These may affect travel times.

Road users are asked to follow the reduced speed limit in place, the direction of traffic controllers and road work signs.

We thank you for your patience while we complete this important work. Please contact the Sydney Gateway team if you have any questions.

Changes to the cycle and pedestrian path

We will have detours in place on the existing cycle and pedestrian path at the two western locations of our work - in orange on the map over the page.

Detours will be short in distance and in the vicinity of the existing path. Signage will be installed onsite informing path users.

Work at these two sites will take place from the end of June to the end of September, weather permitting.

When we are working, path users are asked to follow the signs and directions of our team members at all times.

Location of investigations



Pedestrian and cycle path management

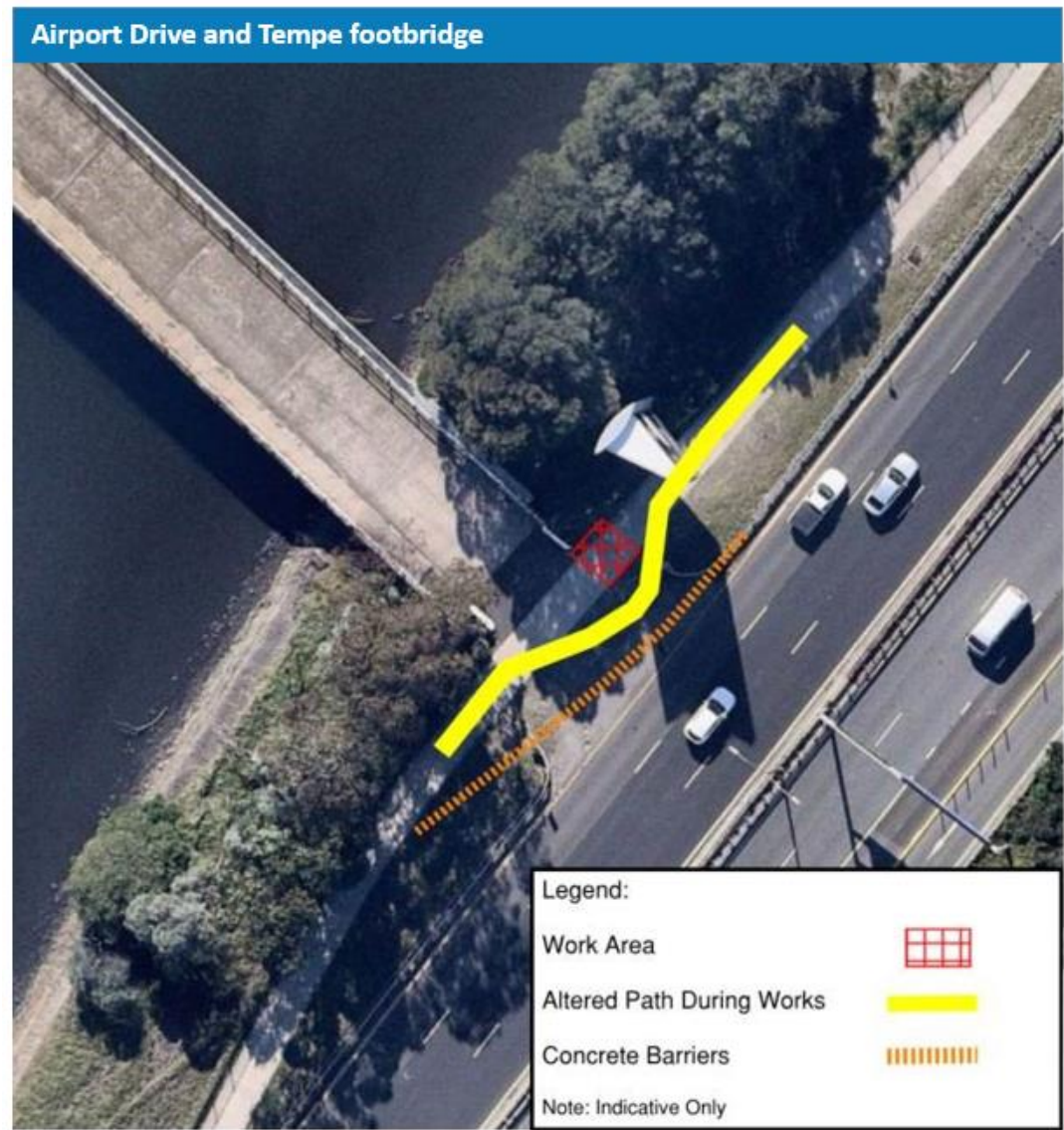

Airport Drive – Pathway management

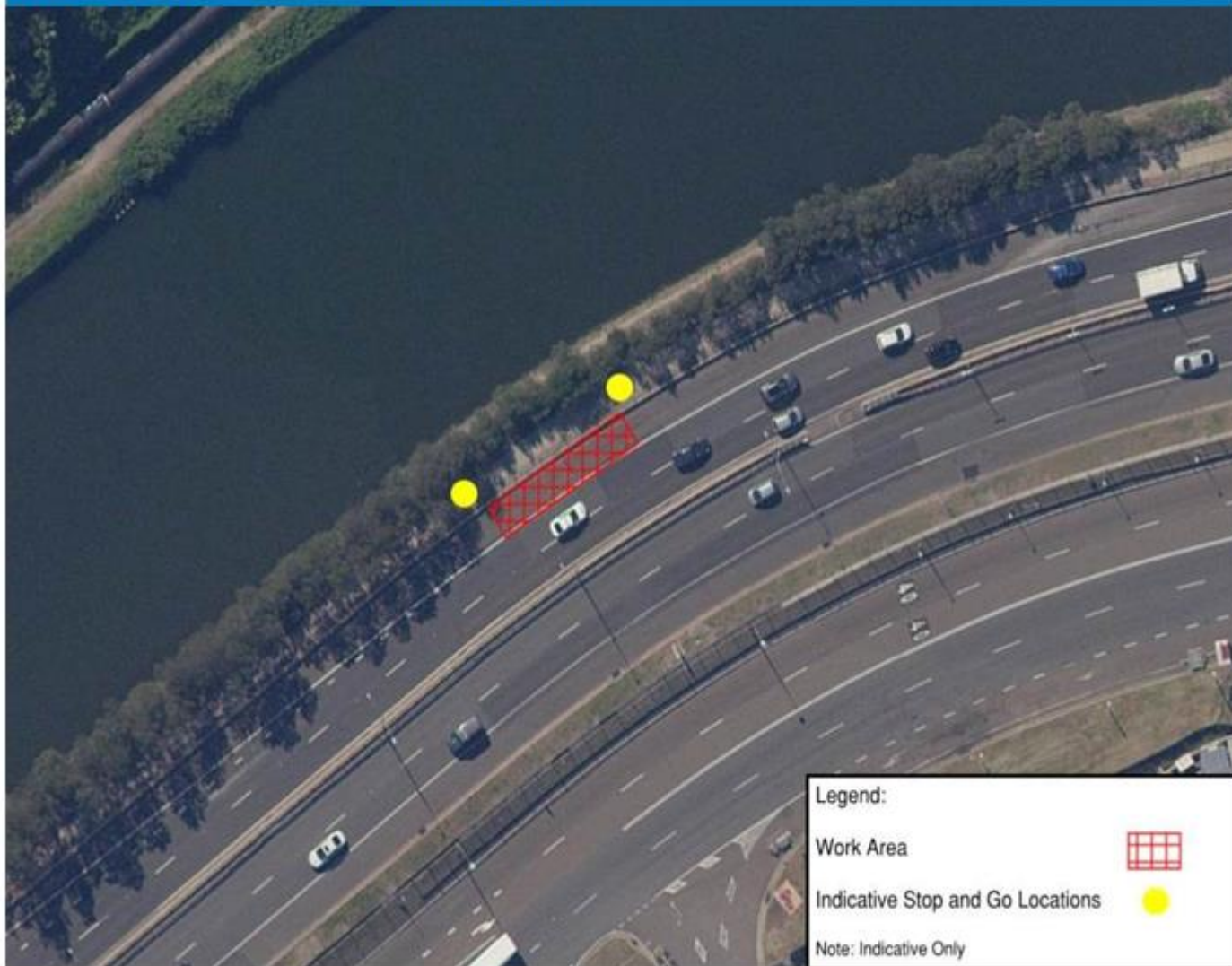

For the latest traffic updates

Call **132 701** Visit [livetraffic.com](https://www.livetraffic.com) Download the App **Live Traffic NSW**



Contact our team

Thank you for your patience while we complete this important work. Please contact us if you have more questions.

 nswroads.work/sydneygatewayportal
 sydneygateway@transport.nsw.gov.au
 1800 654 446
 Transport for NSW
Locked Bag 928, North Sydney NSW 2059



If you need help understanding this information, please contact the Translating and Interpreting Service on **131 450** and ask them to call us on **1800 654 446**.

Privacy Transport for NSW are collecting your personal information in connection with the Sydney Gateway ("the Project"). In addition to collecting your name and contact details we may collect other information such as your submissions and other communications with us. We will retain and use this information for consultation purposes, including communications and analysis in connection with the Project. We will not disclose your personal information to third parties unless authorised by law and if we include your submissions in any public report we will not identify you. Providing your personal information is voluntary but if you do not provide it we may not include you on our stakeholder database and you might miss further consultation opportunities. Your personal information will be held by us and you can contact us to access or correct it. Please write to us at sydneygateway@transport.nsw.gov.au or call on 1800 654 446.